

Part finder

SMD and THR/THD connectors



ZIERICK MANUFACTURING CORPORATION

WIRE TO BOARD INTERCONNECT OPTIONS

32 AWG 0.00795" 0.202mm 0.0320mm ²	30 AWG 0.010" 0.255mm 0.0509mm ²	28 AWG 0.0126" 0.321mm 0.0810mm ²	26 AWG 0.0159" 0.405mm 0.129mm ²	24 AWG 0.0201" 0.511mm 0.205mm ²	22 AWG 0.0253" 0.644mm 0.326mm ²	20 AWG 0.032" 0.812mm 0.518mm ²	18 AWG 0.0403" 1.02mm 0.823mm ²	16 AWG 0.0508" 1.29mm 1.31mm ²	14 AWG 0.0641" 1.63mm 2.08mm ²	12 AWG 0.0808" 2.05mm 3.31mm ²	Coaxial Cable	
IPC-4-45-T (SM)												
								1293 (SM)				
				1262 / 1275 (SM)								
										IPC-2-1-T (SM)		
		1245 / 1296 / 1227 (SM)										
	1235 (SM)											
				1307 (SM)								
	1301 (SM)											
					1295 (SM)							
							1300-T (SM)					
								1174 (TH)				
						1286 (SM)						
					5044 / 5088 (TH)							
				1306-Wxx (SM)								
				1108-TORX-T (SM)								
				1030 / 1108 / 1117 / 934 ST.S (TH)								
	6114 (TH)											
							6072 (TH)					
	1182 / 1183 (TH)											
							6205 (TH)					
				1119 (TH)								
				1185 (TH)								
				1187 (TH)								

Connection Type	Insulation Displacement Connector (IDC)
	Insulation Piercing Terminal (SMIPT)
	Binding Post/Screw Terminal
	Wire Crimp Terminal
	Box Contact

Mounting Type
xxxx (SM) - Surface Mount
xxxx (TH) - Thru-Hole

©2016 Zierick Manufacturing Corporation | 800-882-8020 | www.zierick.com | WTB-1016

Werner Wirth GmbH

Hellgrundweg 111
22525 Hamburg
Germany

Tel +49 (0)40 752 491-0
Fax +49 (0)40 752 491-91

info@wernerwirth.de
www.wernerwirth.de

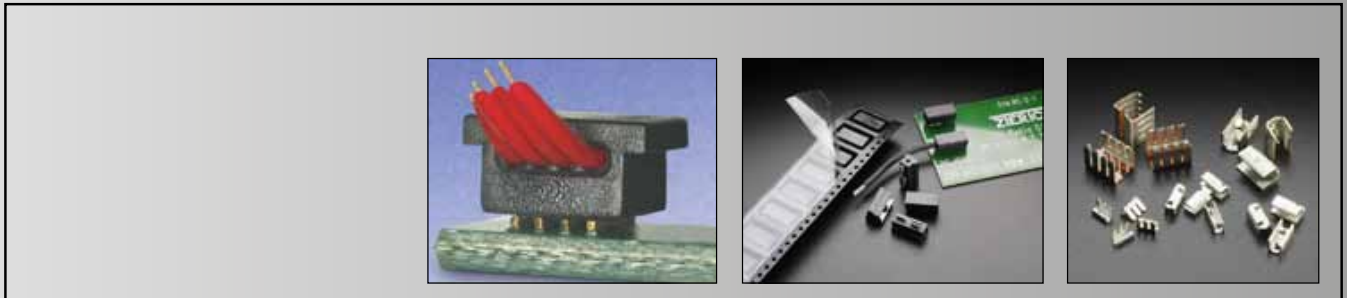

Box (Examples)

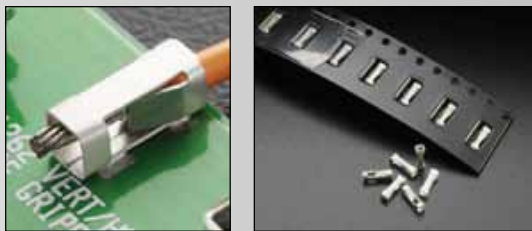

Wire Crimp (Examples)

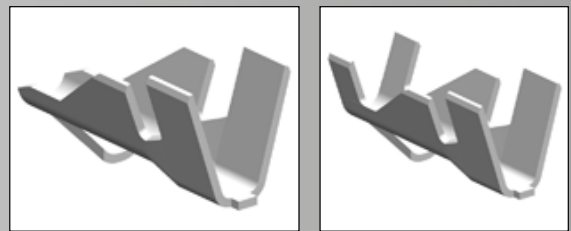

Insulation Displacement Connector (IDC - Examples)

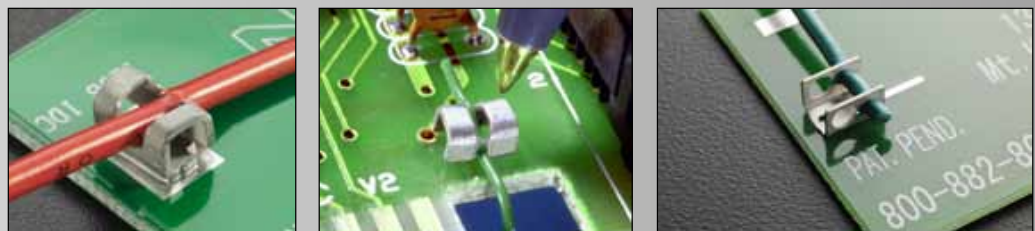

Binding Post (Examples)

